

SHIP MARK	DIV	ASS'M MARK	NO. PCS	SECTION	LENGTH		CHEMISTRY	WEIGHT	P.O. NUMBER	REMARKS	PG / ITEM
					FT.	IN.					
1B6	1		5	W10X33	14'-4		A992	473.6			1/3
		a1001	5	L8X6X5/8	14'-1		A36	400.7			
		a1004	15	L3-1/2X3-1/2X5/16	1'-0 9/16		A36	7.5			
		p1001	15	PL3/8"X4"	0'-4 1/2		A36	1.9			
		p1002	15	PL3/8"X4"	0'-4 1/2		A36	1.9			
TOTAL WEIGHT FOR 1 ASSEMBLY								908.2			

NOTE: ALL WORKSHOP BOLTS SHALL BE TIGHTENED BY THE "SNUG-TIGHT" CONDITION AS DEFINED BY AISC, U.O.N.

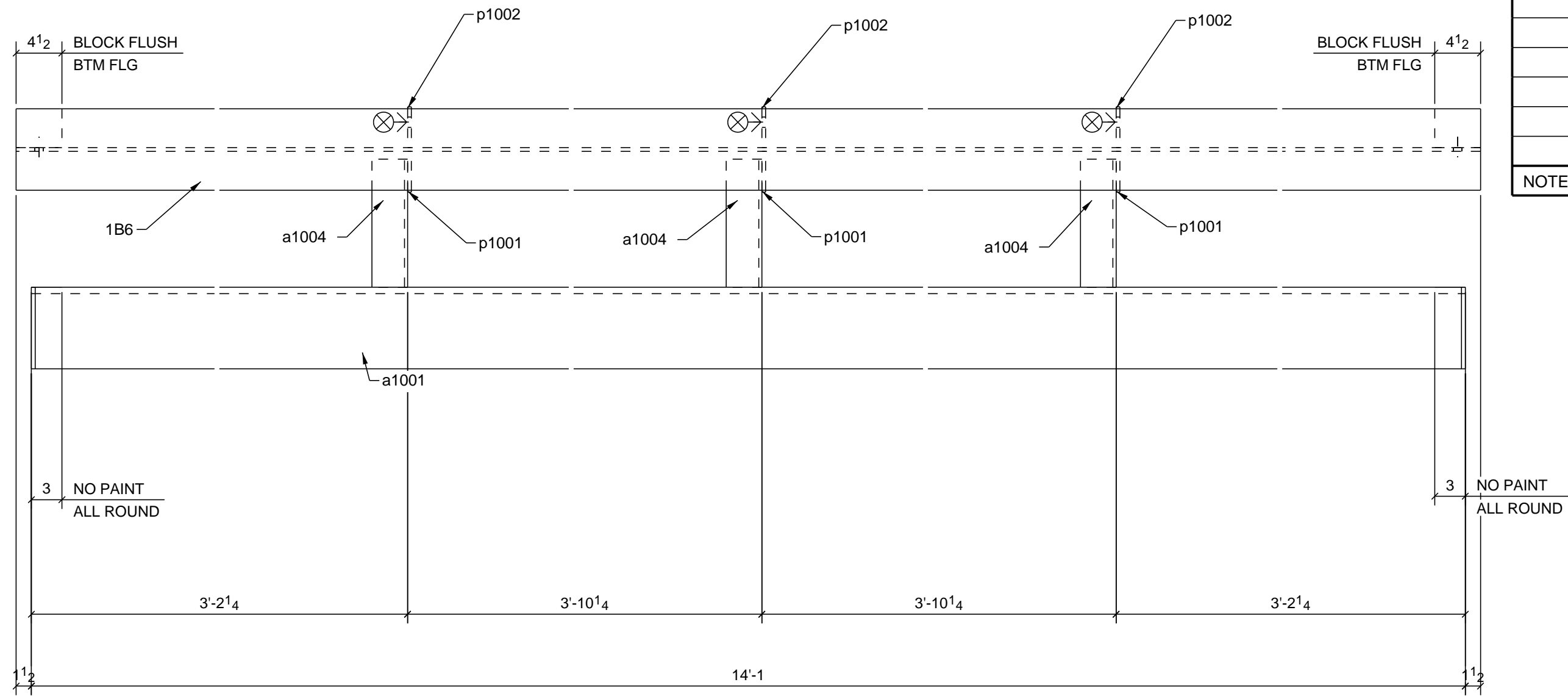

B - B

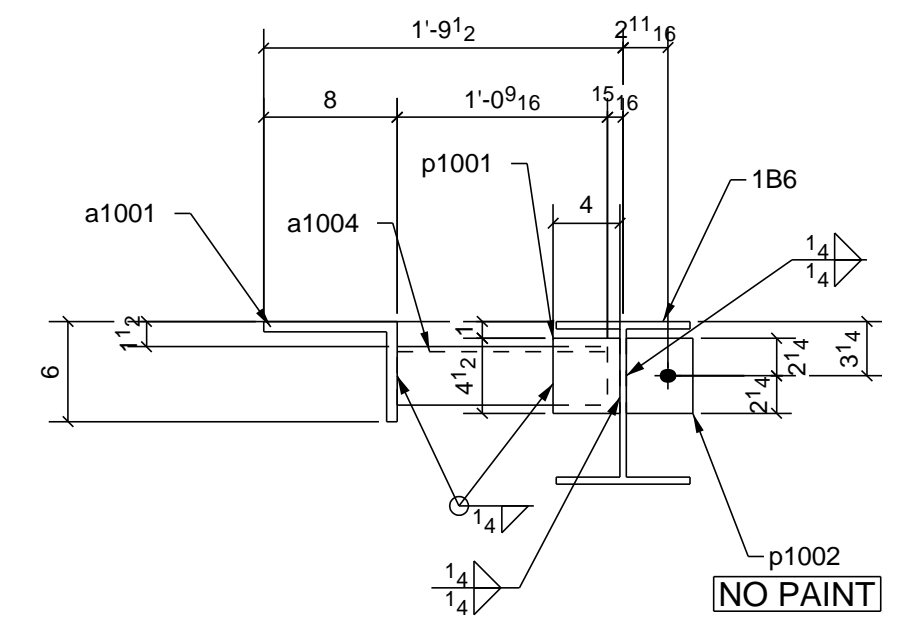

A - A

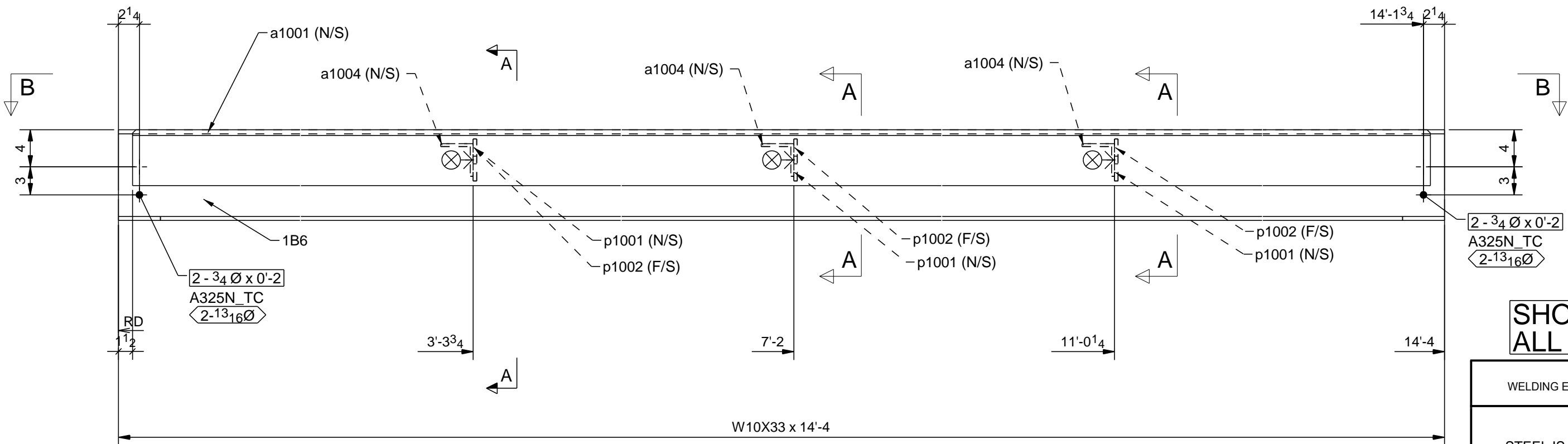

W10X33 x 14'-4

**SHOP NOTE.**  
ALL WELDS TO BE AESS

WELDING ELECTRODE E70XX/LH UNLESS NOTED		STEEL SPEC. W-SHAPES ASTM A992 HOLLOW STRUCTURAL SHAPES ASTM A500-B ALL OTHER MATERIAL ASTM A36 UNLESS NOTED		HOLE SIZE 13/16Ø	
<p><b>ERECTOR'S NOTE</b> STEEL IS FABRICATED WITH "ERECTION MARKS" ON LEFT HAND END OF MEMBERS</p> <p>ALL HOLES IN BEAM END CONNECTION CLIP ANGLE OUTSTANDING LEG SHALL BE 13/16x1 HORIZ SLOTS U.O.N.</p> <p>PREP <u>SSPC-SP2</u></p> <p>SHOP PAINT <u>1-S/C STD SHOP PRIMER</u></p> <p>REF DWG.: <u>E2, E2/1</u></p>					
NO.	DATE	BY	DESCRIPTION OF REVISION		
0	05/31/17	MR	FOR FAB		
A	05/04/17	MR	FOR APPL		
<p>RICHMOND, VA (804)355-7481      RONA, VA. (404)248-1009</p>					
PROJECT	NORFOLK SOUTHERN RAILWAY CANOPIES				
LOCATION	NORFOLK AVE, ROANOKE, VA				
ARCHT.	CROUCH ENGINEERING				
CONTR.	FAULCONER CONSTRUCTION Co.				
			MADE	MR	04/28/2017
			CHKD.	MJK	05/31/17
			ORDER NO.	27-509	
			SHEET NO.	1B6	

5 - BEAMS - 1B6

Conn. Code

W	9 3/4 x 5/16
F	8 x 7/16

Conn. Code

ITEMS

SEQ 1